

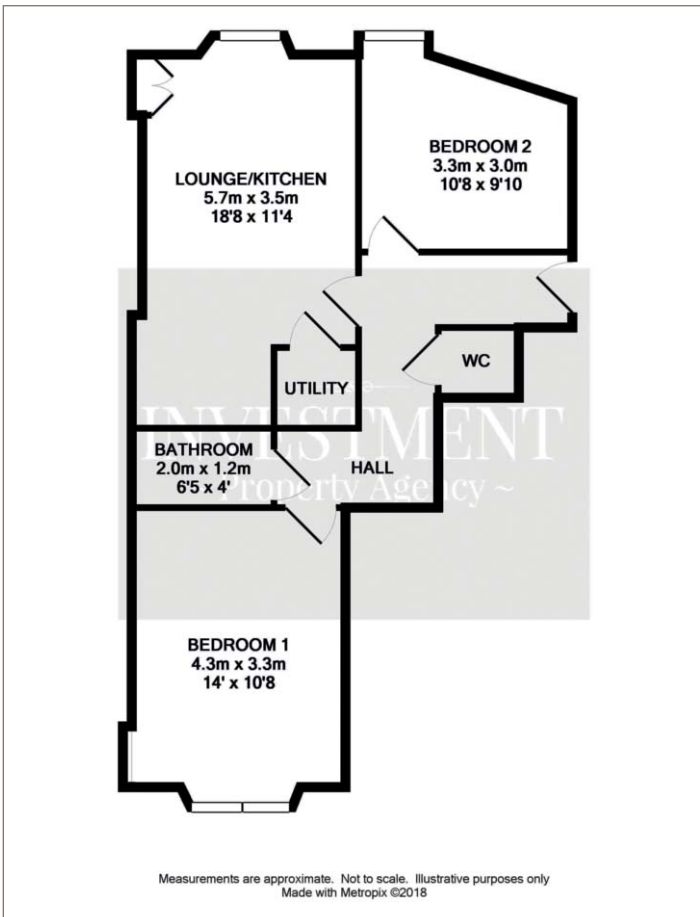

15 Tarvit Street
EH3 9LB

Spacious and flexible 1st floor flat, in popular city centre location, forming part of a traditional built Victorian tenement.





Hall, rear facing open plan lounge/modern fitted kitchen with appliances, 2 double bedrooms, bathroom with shower above bath and separate W.C. compartment. Laminate flooring. Original period features including detailed corning. Gas central heating. Double glazing. Secure entry phone system.

Tarvit Street, between Brougham Place and Home Street, is ideally placed for all of the amenities and facilities available within the Capital. Within the immediate vicinity there are numerous independent shops, cafes, restaurants and bars along with a Sainsbury's Local, Tesco Express and Scotmid Co-operative. The King's, Traverse and Lyceum Theatres are all nearby along with the Cameo and Odeon Cinemas. Located adjacent to the open spaces of The Meadows and Brunstfield Links, it is also worth noting that a number of the capital's Universities are in close proximity. At the foot of Lothian Road lies Princes Street with a number of major tourist attractions including Princes Street Gardens and Edinburgh Castle a short distance away. Major access roads and Haymarket Railway Station allow for ease of travel out with the city with the local tram link running to Edinburgh International Airport.

Energy Performance Rating C

